

Piston Accumulators



Specification

Capabilities

FCH Piston Accumulators are available in any capacity up to 1350 litres. Capacity is only limited by pressure and available materials. Our standard range is 1 litre up-to and including 150 litres. All units are made to order, and can be custom engineered to suit specific space restrictions.

Pressure

Piston Accumulators are available in any pressure between 5 bar and 2500 bars. The pressure rating is dependant on capacity and/or available materials.

Materials

Our units are available in a variety of materials such as Carbon steel, Stainless steel, Duplex or Super Duplex steels and Aluminium. All come with a choice of material certification options.

Design

Vessels will be in accordance with the PED 97/23/EC for use in Europe and designed to PD5500. Optional 3rd party witness (eg. Lloyds) available. Other design codes can be considered for example ASME VIII Div 1.

Fluid End Connections

To suit customer requirements – e.g. NPT, BSP, Autoclave type or SAE/ASME flanged.

Gas End Connections

To suit customer requirements – e.g. NPT, BSP, Autoclave type or SAE/ASME flanged. Transfer barrier ports, Gas Charging valves (brass and stainless) Gas pressure relief devices e.g. Burst discs and Fuse plugs.

Seals

For low or high temperature applications. Materials typically Nitrile, PTFE, Viton, EPDM and others.

Piston Position Indicators

Carbon Steel Options:

- Tailrod – magnetic operation with visual flapper or magnetic indicator switch.
- Bent tube Indicator - magnetic operation with visual flapper or magnetic indicator switch.
- Tailrod – operating a cam/switch.
- Proximity switch

Stainless Steel Options:

- Piston Magnet - magnetic operation with visual flapper or magnetic indicator switch
- Proximity switches



Nº E201480

Version 1.2 - 18/03/2008

➤ Dúvidas ou esclarecimentos, favor contatar nosso depto técnico.

Distribuidor autorizado para todo o Brasil

MAGRAL[®]
HIDRÁULICA E PNEUMÁTICA
www.magral.com.br - 11 2021-7202

Carbon Steel Units

Design Pressure (PS)	Internal Diameter (Ø d)												
	50	80	100	125	160	200	250	280	320	400	501	600	
150													
170													
200													
220													
240													
250													
270													
275													
280													
300													
350													
370													
390													
450													
455													
490													
530													
760													
863													
950													
1035													
1050													
1380													
1500													
2100													

Due to our wide range of product sizes we are unable to display every option available therefore the adjacent table displays a selection of our most commonly requested sizes.

For further information please contact a member of our sales team.

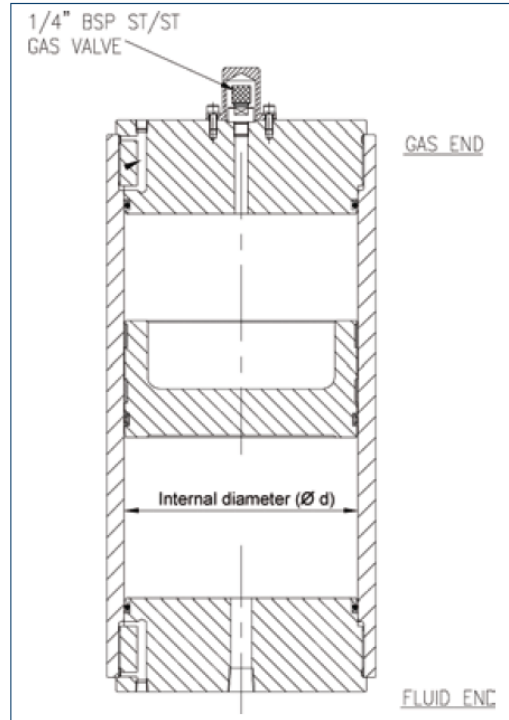

Stainless Steel (17/4 PH)

Design Pressure (PS)	Internal Diameter (Ø d)												
	50	80	100	125	160	200	250	280	320	400	501	600	
455													
600													
690													
760													
863													
960													
1050													
1380													
1500													
2100													

Stainless Steel (AISI 316)

Design Pressure (PS)	Internal Diameter (Ø d)												
	50	80	100	125	160	200	250	280	320	400	501	600	
150													
220													
230													
250													
320													
350													
425													
455													
550													
630													
750													
760													



Nº E201460

➤ Dúvidas ou esclarecimentos, favor contatar nosso depto técnico.

Distribuidor autorizado para todo o Brasil

MAGRAL
HIDRÁULICA E PNEUMÁTICA
www.magral.com.br - 11 2021-7202