

# SCH

## DESCRIPTION

The AMC MECANOCAUCHO® SCH type mounts are made of two parts of rubber, one of which bears an inside metal bushing which acts as a guide through the machine anchoring screw.

It is installed pre-compressed on the actual machine frame, whose thickness "E" determines the degree of precompression.

## TECHNICAL CHARACTERISTICS

This antivibration mount is ideal for applications of major dynamic loads where movement control is necessary, such as in the cabins of all types of mobile vehicles. It also offers optimal stability, as well as good attenuation of impacts and vibrations.

## APPLICATIONS

- Vehicle cabins.
- Public works and agricultural vehicles, etc.

## ASSEMBLY INSTRUCTIONS

The SCH mounts should be assembled according to the following installation instructions. There are two possible configurations, see assembly 1 and assembly 2, for which the recommendations given in the following chart must be observed. They can be installed in plates of different thicknesses according to the T<sub>max</sub> and T<sub>min</sub> values given in the table at the bottom. The Load vs. Deformation curves will vary according to the thickness of the plate on which the mount is to be installed.

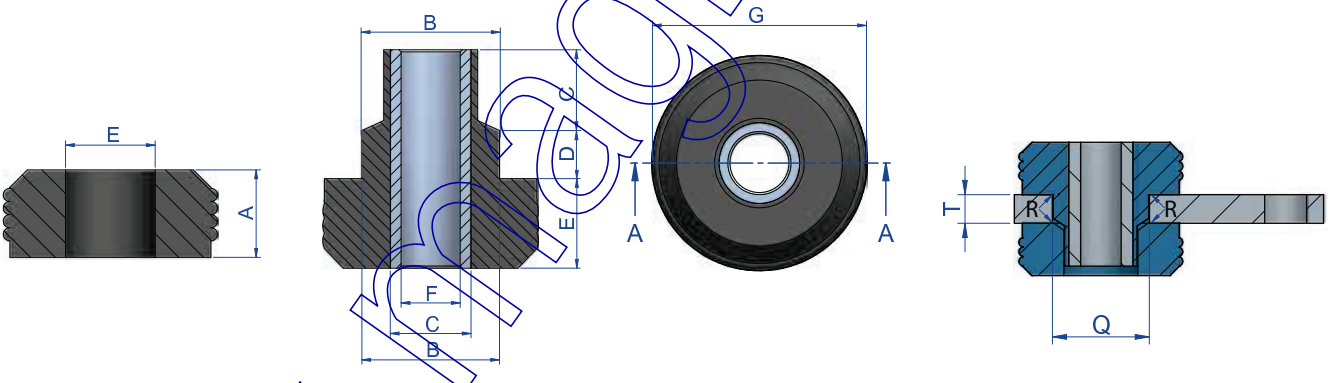

Washers should be used, if the rubber surface is not covered with the contact surface.  
Washers upon request.

Type	A (mm.)	B (mm.)	C (mm.)	D (mm.)	E (mm.)	F (mm.)	G (mm.)	Q (mm.)	T (Max.)	T (Min.)	Weight (gr.)	R (mm.)	Code	Shore	Max. Load (Kg.)
SCH 50	20	31,5	18,5	11	20,5	13,5	49	30,8	14	12,5	153	1,5	138501	45 Sh	80
													138504	60 Sh	130
SCH 65	25	39,5	24	15	23	17	63,5	38,5	22	19	350	2,5	138502	45 Sh	120
													138505	60 Sh	260
SCH 90	25	58	31	17	25	23	88	57	29	25	675	3	138503	45 Sh	260
													138506	60 Sh	450
SCH 125	32	64,5	32,5	22	32	27	125,5	64	32	25	1440	3	138514	50 Sh	650
													138515	60 Sh	800

Type	Code	Øext (mm.)	Øint (mm.)	THICKNESS (mm.)
SCH 50 WASHER	611080	54	13,5	4
SCH 65 WASHER	606130	67	16,5	5
SCH 90 WASHER	608101	96	22	6
SCH 125 WASHER	610123	125	25	8

- Assembly 1

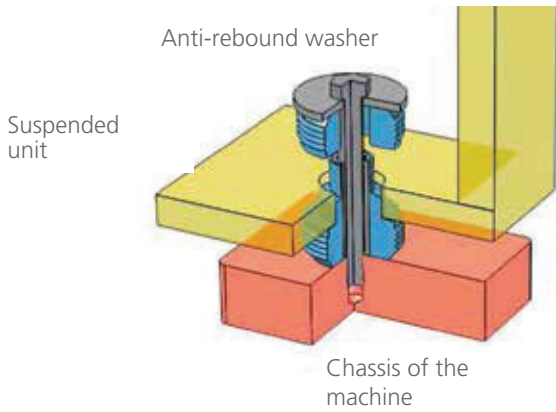

- Assembly 2

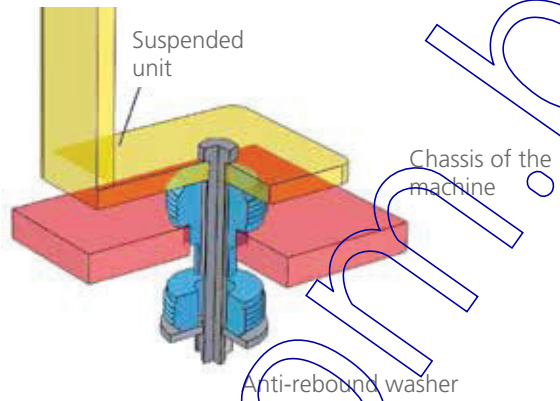

NATURAL FREQUENCY  
AMC MECANOCAUCHO® SCH TYPE

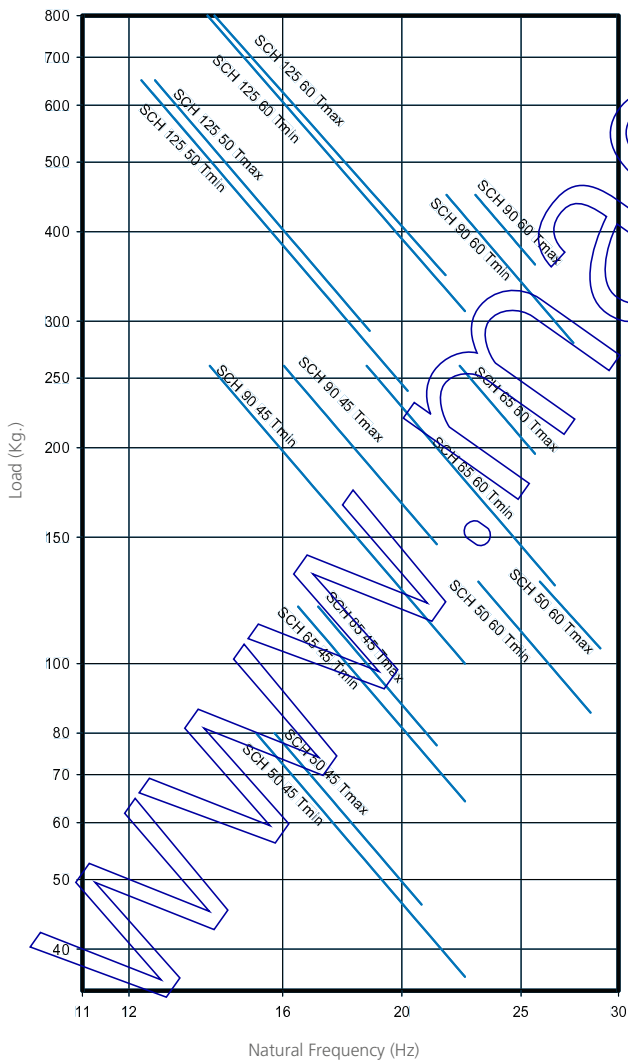

LOAD DEFLECTION GRAPH  
AMC MECANOCAUCHO® SCH TYPE

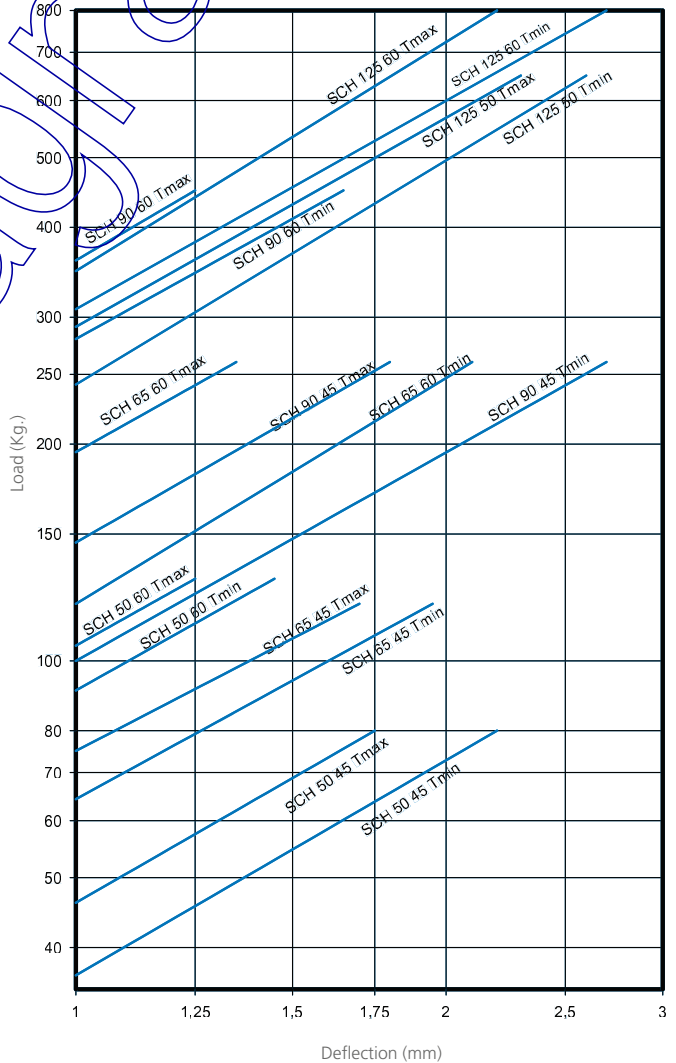

\* In order to adapt its products to the state of the art, AMC .A. reserves the right to modify the conception and manufacture of the materials presented in this catalogue without prior notice.

# SCHR

## DESCRIPTION

The AMC MECANOCAUCHO® SCHR type mounts are made of two parts of rubber, one of which bears an inside metal bushing which acts as a guide through the machine anchoring screw. It is installed pre-compressed on the actual machine frame, whose thickness "E" determines the degree of precompression.

Moreover it contains a metallic part, that avoids a premature wear by friction between the rubber and the housing of the mount.

## TECHNICAL CHARACTERISTICS

This antivibration mount is ideal for applications of major dynamic loads where movement control is necessary, such as in the cabins of all types of mobile vehicles. It also offers optimal stability, as well as good attenuation of impacts and vibrations.

## APPLICATIONS

- Vehicle cabins
- Public works and agricultural vehicles, etc.

## ASSEMBLY INSTRUCTIONS

The SCH mounts should be assembled according to the following installation instructions. There are two possible configurations, see assembly 1 and assembly 2, for which the recommendations given in the following chart must be observed. They can be installed in plates of different thicknesses according to the T<sub>max</sub> and T<sub>min</sub> values given in the table at the bottom. The Load vs. Deformation curves will vary according to the thickness of the plate on which the mount is to be installed.

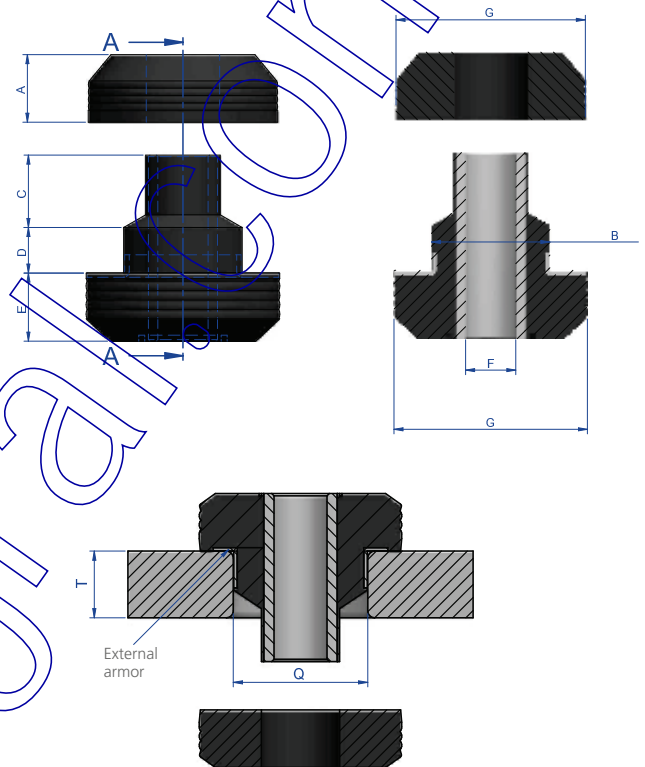

Type	A (mm.)	B (mm.)	C (mm.)	D (mm.)	E (mm.)	F (mm.)	G (mm.)	Q (mm.)	T (Max.)	T (Min.)	Weight (gr.)	Code	Shore	Max. Load (Kg.)
SCHR 35	11	20,1	10	5	11	8,5	34,5	20,4	6	6	42	<b>138621</b>	45 Sh	40
												<b>138623</b>	60 Sh	80
SCHR 50	20	31,5	18,5	11	20,5	13,5	49	31,8	14	12,5	153	<b>138535</b>	45 Sh	80
												<b>138534</b>	65 Sh	150
SCHR 65	23	39,5	24	15	23	17	63,5	40	22	19	350	<b>138551</b>	50 Sh	160
												<b>138552</b>	65 Sh	300
SCHR 90	25	58	27	17	25	23	88	58,5	29	25	675	<b>138547</b>	45 Sh	260
												<b>138548</b>	60 Sh	450
SCHR 125	32	63,4	32,5	22	32	27	125,5	65,8	32	25	1440	<b>138216</b>	50 Sh	650
												<b>138217</b>	60 Sh	800
SCHR 140	35	70	31	13	35	31	140	71	20	20	1900	<b>138508</b>	45 Sh	700
												<b>138510</b>	60 Sh	2000

Washers should be used, if the rubber surface is not covered with the contact surface.  
Washers upon request.

Type	Code	Øext (mm.)	Øint (mm.)	THICKNESS (mm.)
WASHER SCHR 35	<b>610053</b>	38	8,5	2
WASHER SCHR 50	<b>611080</b>	54	13,5	4
WASHER SCHR 65	<b>606130</b>	67	16,5	5
WASHER SCHR 90	<b>608101</b>	96	22	6
WASHER SCHR 125	<b>610123</b>	145	25	6
WASHER SCHR 140	<b>608115</b>	145	30	10

- Assembly 1

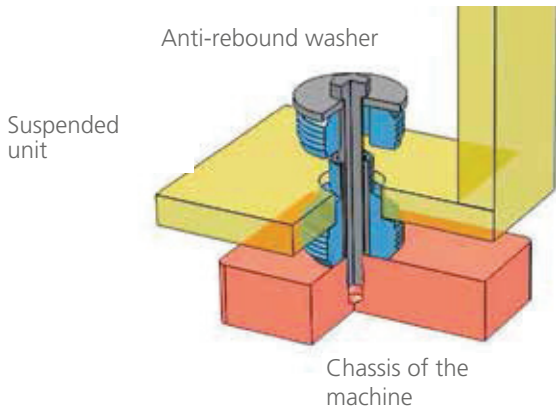

- Assembly 2

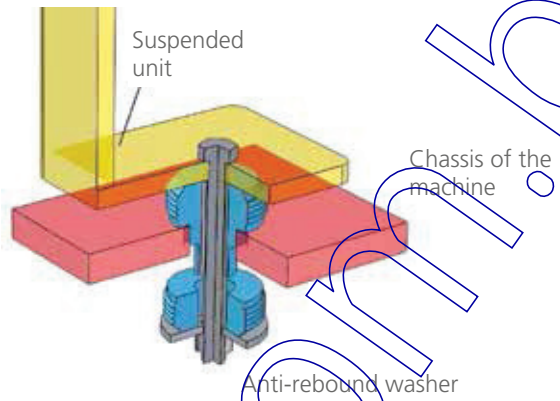

NATURAL FREQUENCY  
AMC MECANOCAUCHO® SCHR TYPE

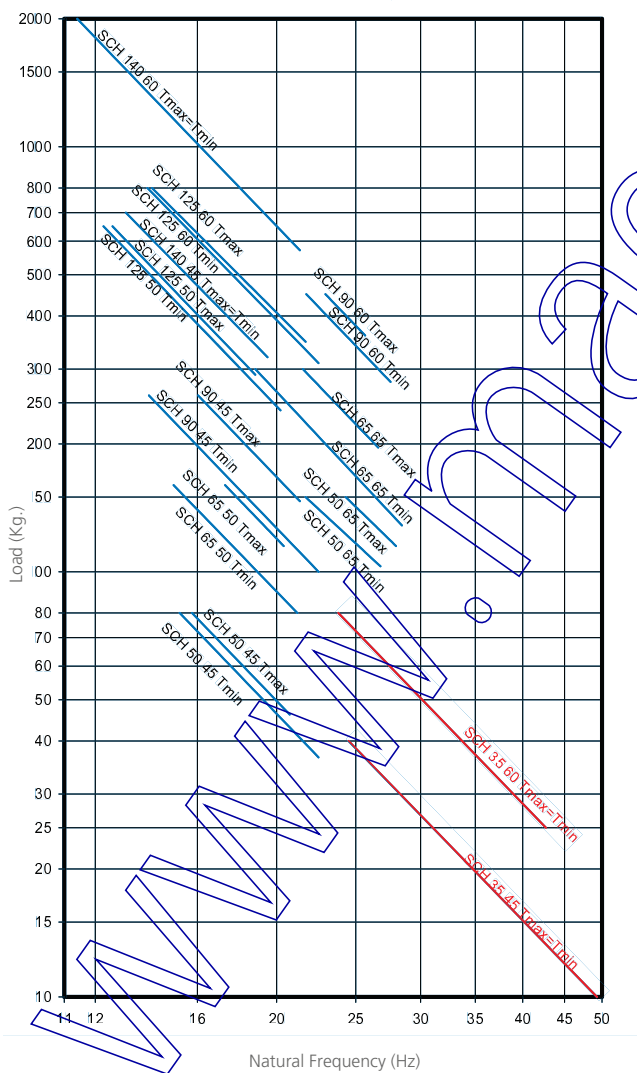

LOAD-DEFLECTION GRAPH  
AMC MECANOCAUCHO® SCHR TYPE

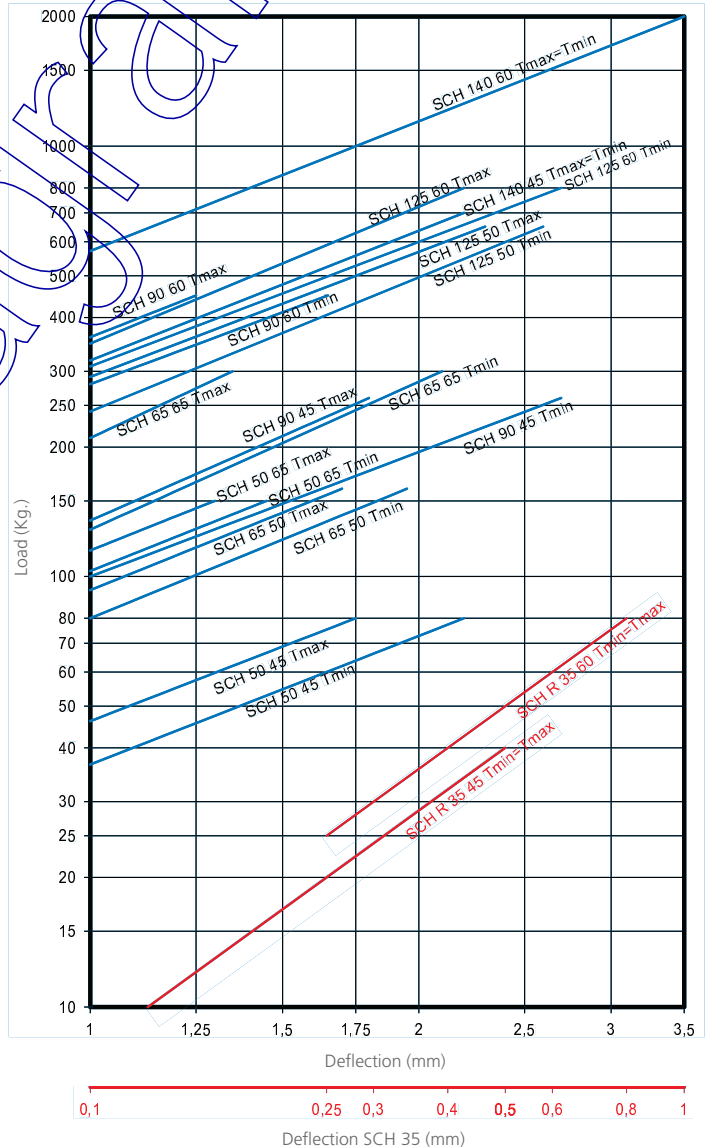

\* In order to adapt its products to the state of the art, AMC .A. reserves the right to modify the conception and manufacture of the materials presented in this catalogue without prior notice.